

# TONDI UNI

EU 60  
UNI EN 10060

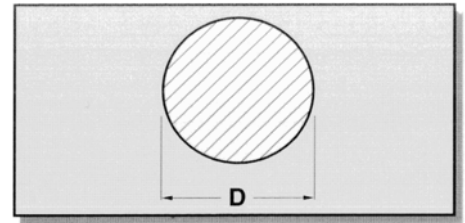

| D  | Peso Kg/m |
|----|-----------|
| 6  | 0,222     |
| 8  | 0,395     |
| 10 | 0,617     |
| 12 | 0,888     |
| 14 | 1,210     |
| 15 | 1,387     |
| 16 | 1,578     |
| 18 | 2,000     |
| 20 | 2,466     |
| 22 | 2,984     |
| 24 | 3,551     |
| 25 | 3,853     |
| 26 | 4,170     |

| D  | Peso Kg/m |
|----|-----------|
| 28 | 4,834     |
| 30 | 5,550     |
| 32 | 6,313     |
| 34 | 7,130     |
| 35 | 7,550     |
| 40 | 9,865     |
| 42 | 10,876    |
| 45 | 12,500    |
| 50 | 15,414    |
| 55 | 18,700    |
| 60 | 22,200    |
| 65 | 26,000    |
| 70 | 30,210    |

| D   | Peso Kg/m |
|-----|-----------|
| 75  | 34,700    |
| 80  | 39,500    |
| 85  | 44,500    |
| 90  | 49,940    |
| 95  | 55,643    |
| 100 | 61,600    |
| 105 | 68,000    |
| 110 | 74,601    |
| 115 | 81,537    |
| 120 | 88,800    |
| 125 | 96,334    |
| 130 | 104,195   |
| 135 | 112,360   |

| D   | Peso Kg/m |
|-----|-----------|
| 140 | 120,842   |
| 145 | 129,630   |
| 150 | 138,722   |
| 155 | 148,120   |
| 160 | 158,000   |
| 170 | 178,180   |
| 180 | 200,000   |
| 200 | 246,616   |
| 220 | 298,400   |
| 230 | 326,150   |
| 240 | 355,130   |
| 250 | 385,340   |